



CALL FOR SUBMISSIONS FOR EXHIBITIONS IN 2019-2020

GALLERY INFORMATION

Smithers Art Gallery is a non-profit organisation which is operated by the Smithers Gallery Association (SGA). The mission of the Smithers Gallery Association is *"Creating community through art"*.

SPACE DESCRIPTION (refer to floor plan on p.2)

As a whole, the gallery measures approximately 121 running feet and can accommodate approximately 30-40 pieces of wall art, depending on size. The gallery can be divided into two connected spaces, referred to as the Main Gallery and the Mini Gallery. The Main Gallery measures approximately 87.5 running feet, and the Mini Gallery 33.5 running feet. The gallery has a large number of plinths for displaying 3D work. Applicants select on the form which space they are applying to be exhibited in – Full Gallery, Main Gallery, or Mini Gallery.

The SGA reserves the right to exhibit two or more artists in the gallery at the same time by displaying one artist in the Main Gallery and one in the Mini Gallery, or by combining different media and displaying 2D artwork on the walls and 3D artwork on the plinths. The SGA receives a large volume of applications and this enables us to maximise the use of the gallery space and accept a larger number of artists who apply to be exhibited.

EXHIBITIONS FOR 2019-2020

The SGA will be considering proposals for exhibitions in all media, to be exhibited from **June 2019 to May 2020**. We welcome exhibition proposals for solo shows or joint/group shows (thematic or non-thematic) from artists, curators, and community members. Exhibitions change every 5 to 6 weeks.

The SGA schedules and advertises its exhibitions a full year in advance. There is an expectation that by submitting an exhibition application, artists are committing to be shown in the Smithers Art Gallery if they are accepted and will have sufficient volume of quality work for the exhibition space applied for. Artists are strongly advised to undertake due diligence into the costs of shipping artwork (if required) before applying for an exhibition. There may be limited funds available to help with shipping costs – please enquire at the Gallery.

MEMBERSHIPS & COMMISSION

Artists are not required to be members to submit an application or be exhibited in the gallery, but members receive a reduced commission rate on sales. The SGA's commission rate is 25% members/35% non-members. Memberships are \$25/year (valid May 1 – April 30) and need to be taken out by the opening date of the exhibition for the reduced commission rate to apply. All exhibitors must have, at minimum, **75% of your displayed works available for sale**.

PREVIOUSLY EXHIBITED ARTISTS

In order to ensure an interesting and varied schedule, the SGA will exhibit an artist in a solo show (Full Gallery or Main Gallery space) not more frequently than once every 3 years.

PROCESS

The deadline for receipt of applications is Tuesday January 15th, 2019. Applications can be submitted by email, mail or in person – please refer to p.3 for the list of supporting documents required. Submissions will be juried by an independent selection committee comprised of artists from the community and headed by the SGA's Art Director. **Artists will be notified of the outcome of their applications by email by January 30, 2019. We respectfully ask that artists do not contact the Gallery to enquire about the status of their applications before this date.**

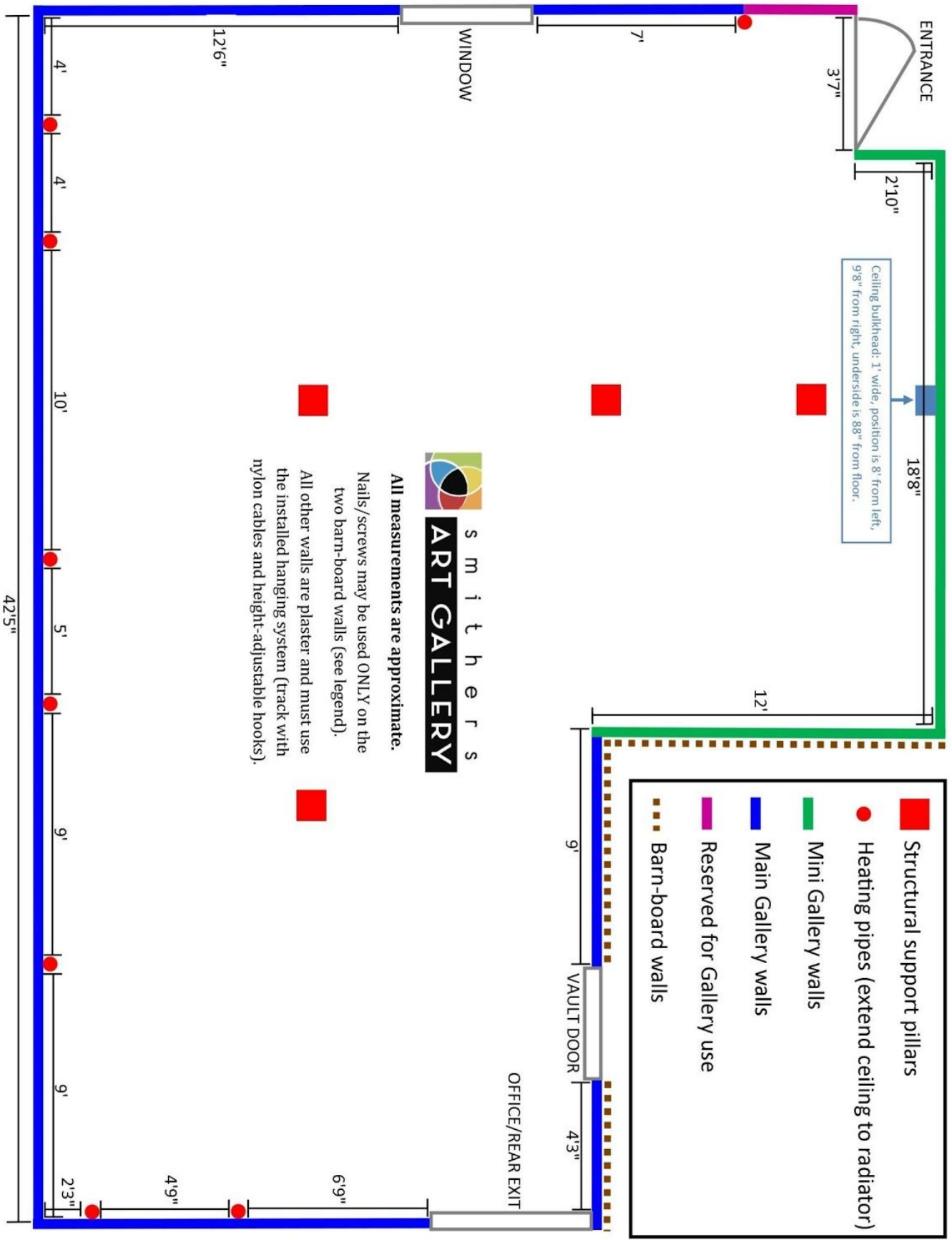

Smithers
ART GALLERY

All measurements are approximate.
 Nails/screws may be used ONLY on the two barn-board walls (see legend).
 All other walls are plaster and must use the installed hanging system (track with nylon cables and height-adjustable hooks).

- Structural support pillars
- Heating pipes (extend ceiling to radiator)
- Mini Gallery walls
- Main Gallery walls
- Reserved for Gallery use
- Barn-board walls

SUPPORTING DOCUMENTATION REQUIRED

1. **COMPLETED APPLICATION FORM** (p.4 only - please keep pages 1-3 of this pack for your reference)
2. **A WRITTEN DESCRIPTION OF YOUR PROPOSED EXHIBITION**, including any technical requirements if applicable
3. **IMAGES:** 10-15 digital images of your work in JPEG format, no larger than 1MB each, clearly labelled with artist name and title. These should either be the work you would actually be exhibiting or representative of the style of work you would be exhibiting.

We recognise that photographing artwork can be challenging but to give the selection committee the best impression of your artwork please ensure that your images are:

- a) in focus
 - b) for 2D artwork, taken from directly in front of the work without distortion/skew
 - c) free from shadows, glare or reflections
 - d) cropped to artwork edges to remove distracting backgrounds
4. **LIST OF IMAGES:** include title, medium, dimensions, and year of production for each piece. Please ensure that the list corresponds correctly to digital image filenames.
 5. **ARTIST'S STATEMENT (100-200 words)** describe the proposed show. This statement will be used by the selection committee and, if chosen, will be used for media purposes
 6. **BIOGRAPHY/CURRICULUM VITAE**
 7. **SELF-ADDRESSED STAMPED ENVELOPE** if you wish to have any materials returned to you by mail.

Submissions received without all of the items in the checklist above will be considered incomplete and will not be reviewed by the Exhibitions Selection Committee

Questions? Contact us!

info@smithersart.org | 250-847-3898

Submit by email, mail, or in person:

info@smithersart.org

Smithers Art Gallery, Box 122, Smithers, BC, V0J 2N0

DEADLINE FOR SUBMISSIONS: TUESDAY JANUARY 15, 2019

EXHIBITION APPLICATION FORM

1. CONTACT INFORMATION

Name _____
Mailing Address _____
Phone _____
Email _____

2. EXHIBITION DETAILS

(please refer carefully to the space description and floor plan to estimate the volume of work required to fill the space)

Exhibition Space Being Applied For:

- Full Gallery (Main & Mini combined)
- Main Gallery only
- Mini Gallery only

Type of Show:

- Solo show
- Non-thematic joint/group show*
- Thematic joint/group show*

** Please supply contact information for all participating artists on a separate sheet. If your show is thematic, please include a proposal describing your artistic idea including who may be involved and what your role would be.*

Media: (e.g. pottery, oil painting, carving, fabric art, photography, etc.)

Number of pieces you will be exhibiting (estimate):

Artwork will include (check all which apply):

- New work (produced in the last 3 years) and/or work not previously exhibited in the Gallery
- Retrospective
- Previously exhibited work not shown within the last 3 years (shown at the discretion of the Art Director)

3. WHICH MONTH/YEAR WOULD YOU PREFER? (JUNE 2019 - MAY 2020)

1st choice: _____ 2nd choice: _____

(We will do our best to accommodate your preferences, but this cannot be guaranteed)

4. WHICH DATE(S) ARE YOU NOT AVAILABLE FOR AN EXHIBITION?

5. AS PART OF OUR OUTREACH PROGRAM, PLEASE INDICATE WHICH OF THE FOLLOWING ACTIVITIES YOU WOULD BE WILLING TO PERFORM:

- Lunchtime artist lecture/demonstration (1hr, weekday)
 - Workshop (usually 2-3hrs, weekday evenings or weekend daytime)
 - Artist talk/demonstration to school groups, seniors groups etc.
 - "Artist-in-residence" (eg painting in the gallery during open hours)
 - Volunteer on duty (to open the Gallery to visitors - can be combined with artist-in-residence)
 - Other (please give details)
-